

A: BATHYMETRY

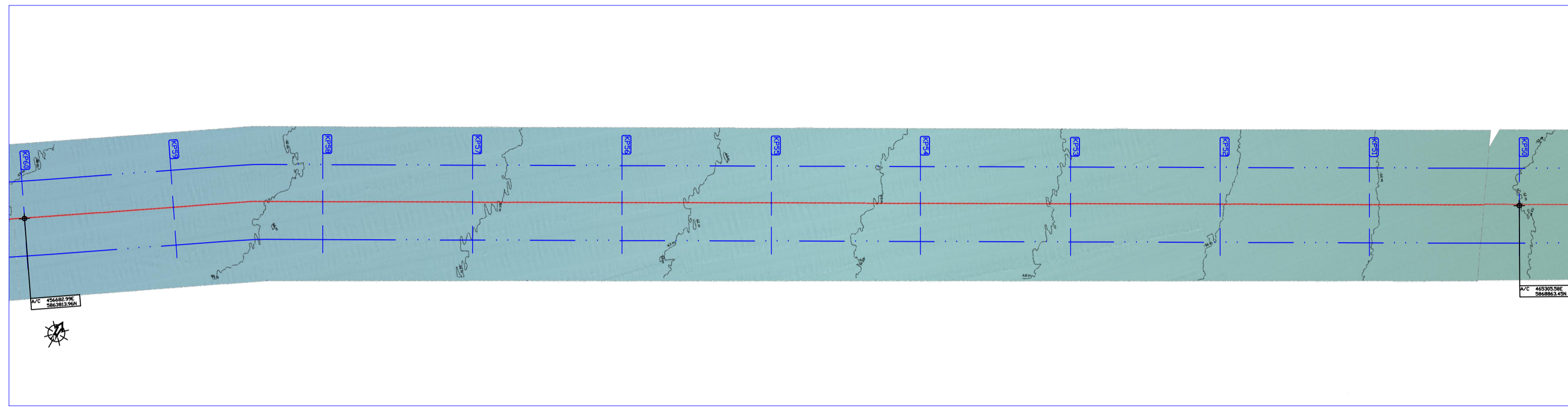

KP60 - KP50

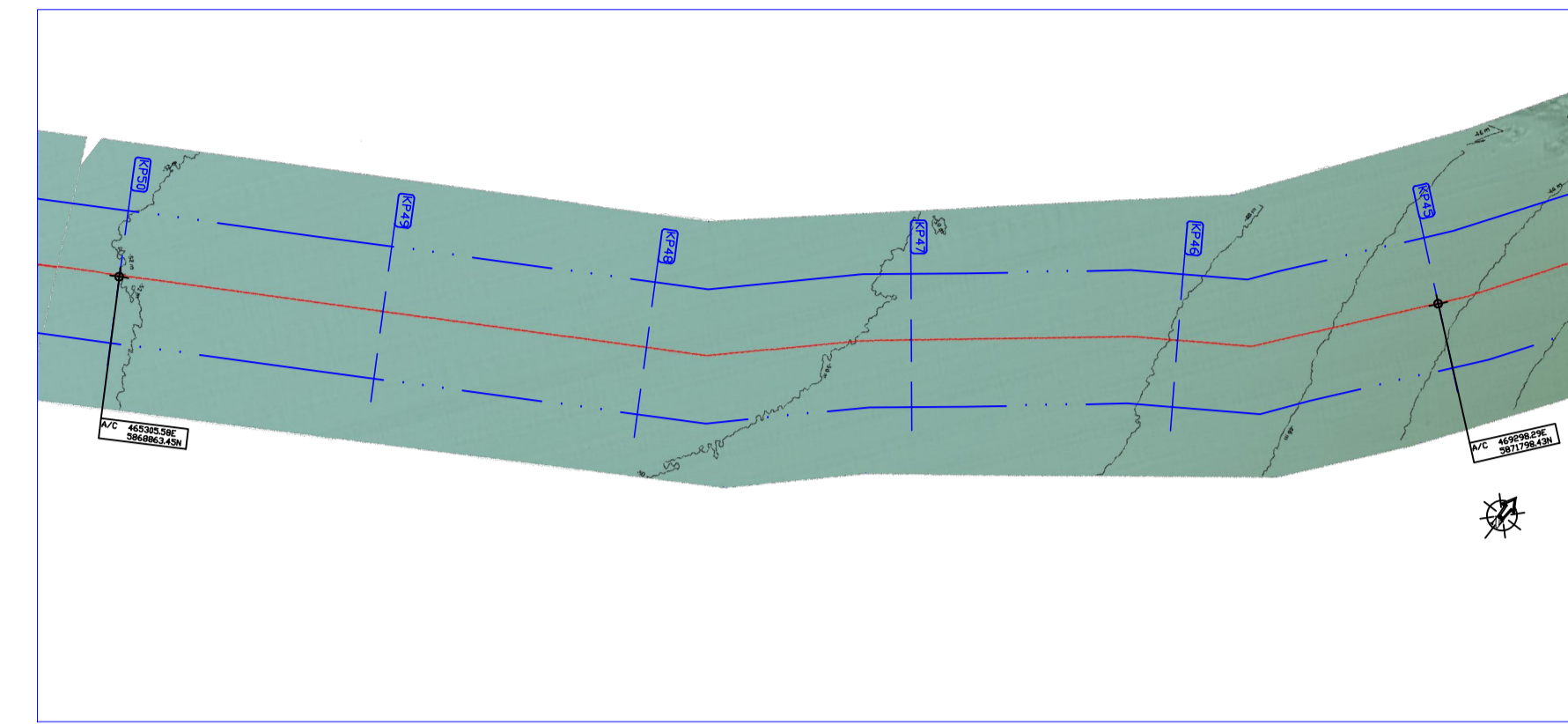

KP50 - KP45

B: SEABED FEATURES - MBES BACKSCATTER

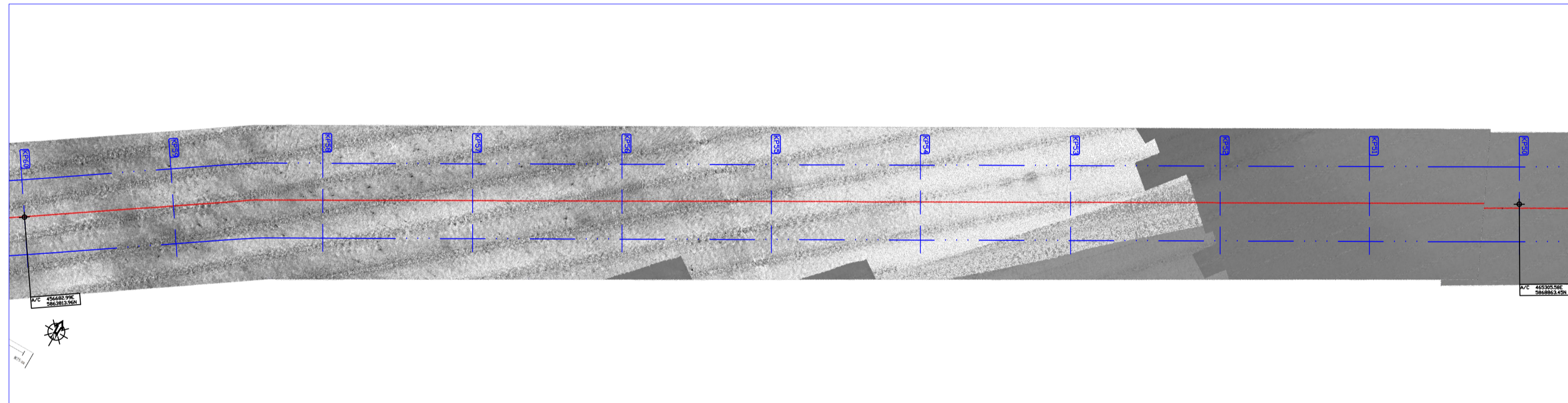

KP60 - KP50

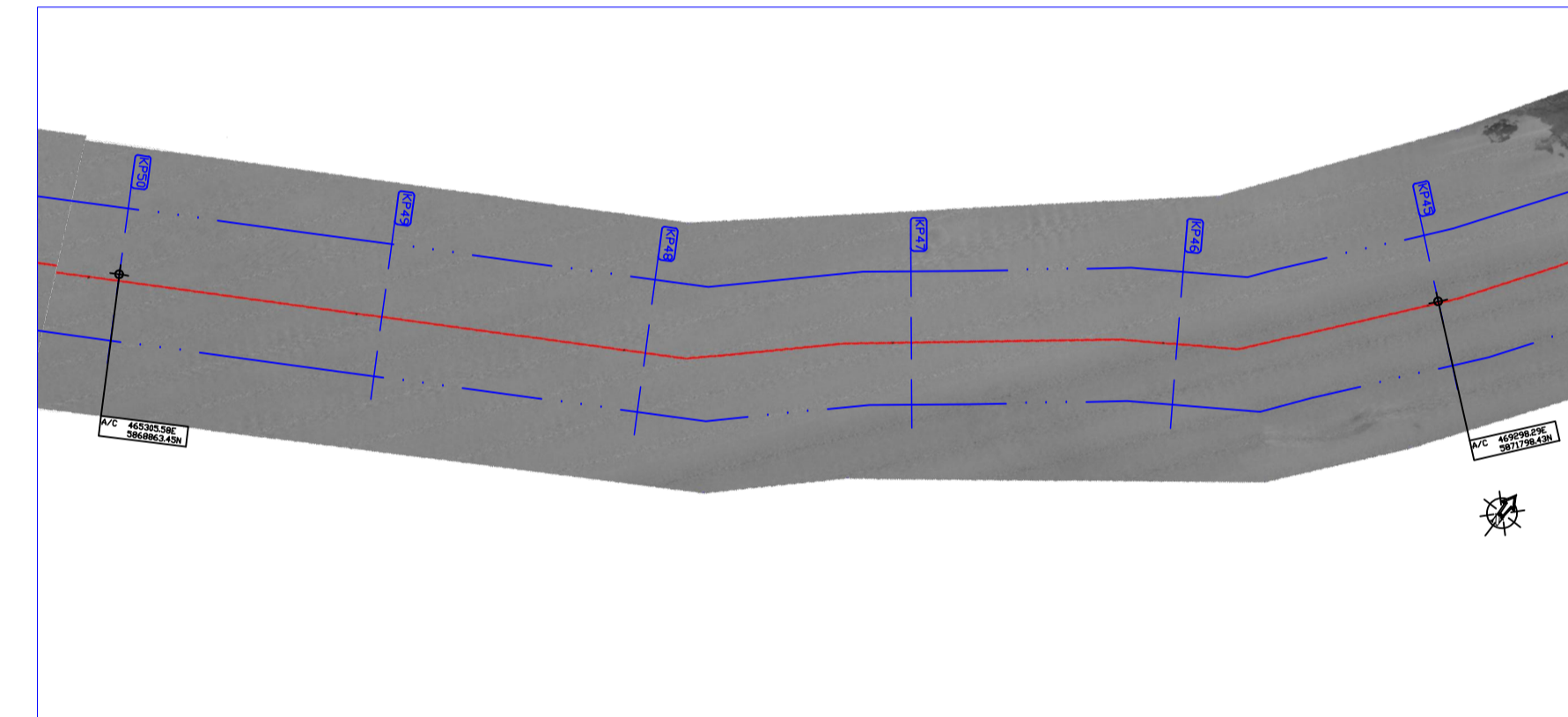

KP50 - KP45

C: INTERPRETED LONGITUDINAL BATHYMETRIC PROFILE

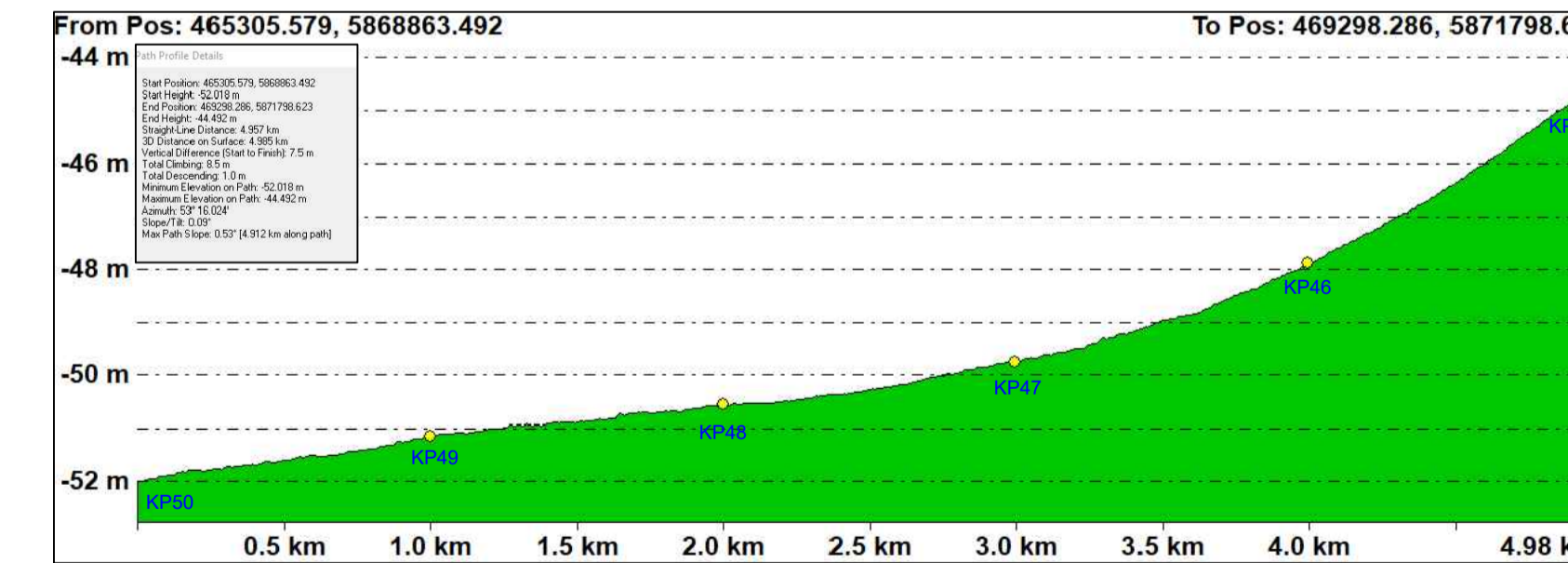
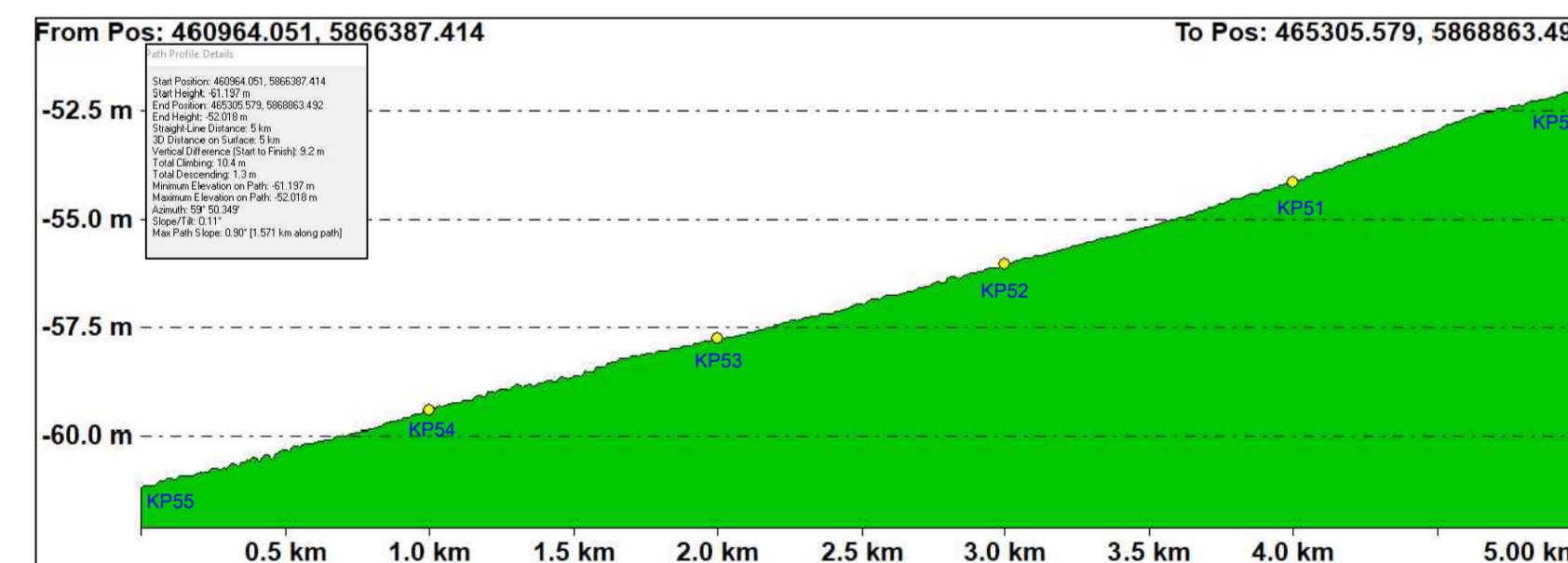
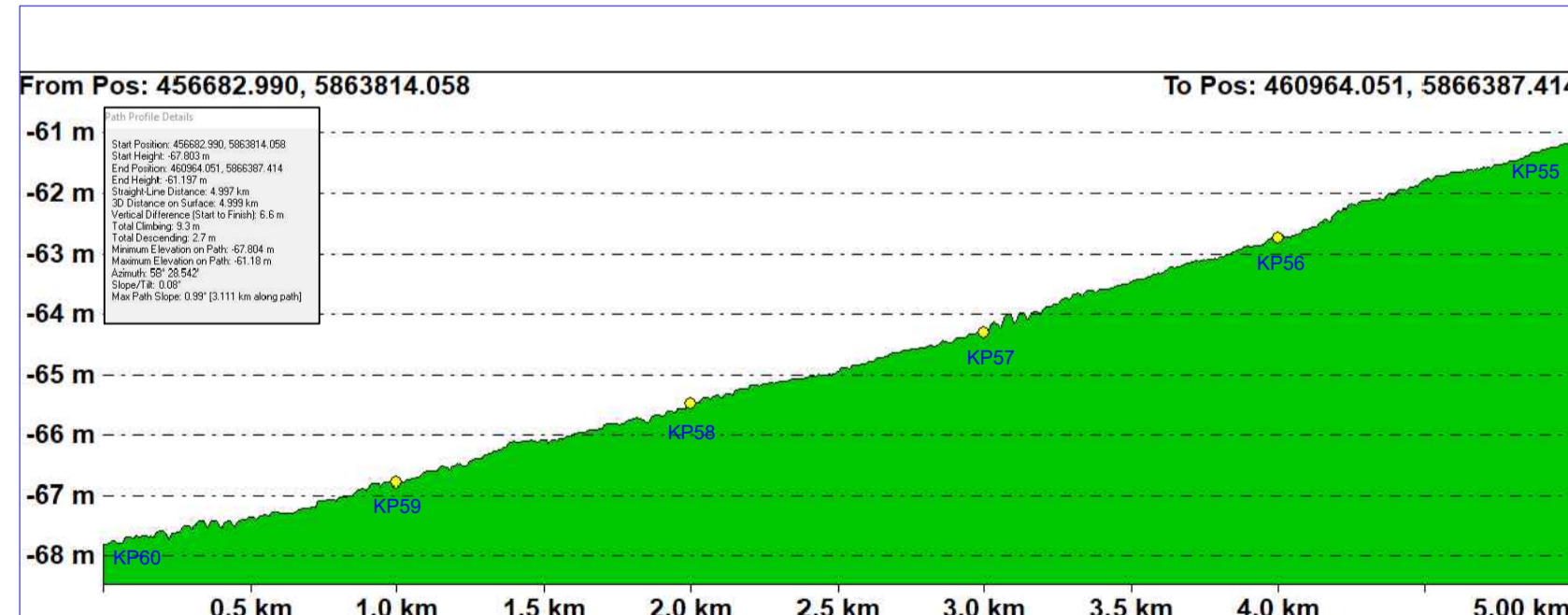

D: ENGINEERING

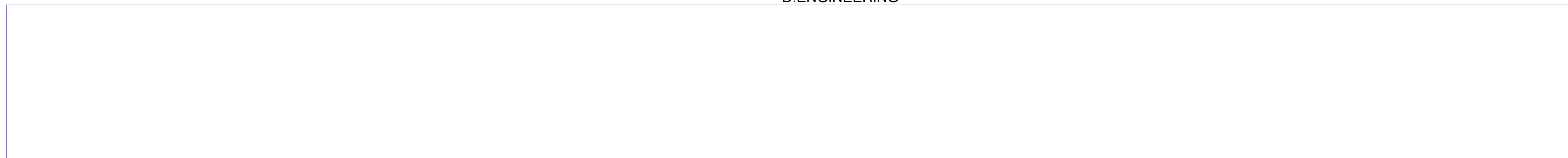

**General Notes**

- HIGH WATER MARK (H.W.M.)
- PROPOSED CABLE ROUTE
- KILOMETRE MARKER POST
- ROUTE CORRIDOR (500M)
- 12 NAUTICAL MILE LIMIT
- ROUTE POINT POSITION

**A: BATHYMETRY**  
SPOT DEPTHS IN METRES LAT  
BATHYMETRY CONTOURS REDUCED TO METRES LAT  
ALL DIMENSIONS IN METRES

**B: SEABED FEATURES**

- No Data
- Class 0 Silt
- Class 0 Rock
- Class 4 Rock (High Texture)
- Class 2 Coarse to Coarse Grains
- Class 2 Coarse to Medium Sand
- Class 1 Fine Sands to Mud
- SAND WAVE CREST
- BOULDER (HEIGHT IN METRES AND ID)
- DEBRIS (DIMENSIONS LxWxH AND ID)
- AREA OF DEBRIS
- LINEAR DEBRIS (LENGTH IN METRES AND ID)
- WRECK (AS FOUND POSITION, DIM'S IN METRES AND ID)
- WRECK WITH POSITION FROM CLIENT AND ID
- MAGNETOMETER ANOMALY IN HT AND ID
- CABLE (AS FOUND POSITION)
- CPT LOCATION AND ID
- SEABED SAMPLE LOCATION AND ID

**C: LOCATION**

**DO NOT SCALE FROM THIS DRAWING**  
**NO LIABILITY FOR OMBRE, OMISSIONS OR EXCEPTIONS WILL BE ACCEPTED BY DEESEA FIBRE NETWORKS LTD**

**GEODETIC INFORMATION**  
Projection: UTM ZONE 29 NORTH CENTRAL MERIDIAN 9° WEST  
Vertical Datum: Adgealty Chart Datum  
Geoidetic Datum: WGS84

No.	Revision/Issue	Date
	Rev 1.1	02/03/18
	Rev 1.2	25/07/18

**Firm Name and Address**  
DeepSea Fibre Networks Ltd  
15 The Seapoint Building,  
Clontarf Road,  
Dublin 3  
Tel: +353-1-8536500  
www.deepseafibre.com

**Project Name:**  
WINS SUBSEA CABLE SYSTEM  
ROUTE CORRIDOR SURVEY DATA  
ALIGNMENT SHEET KP45 - KP60  
Project Number: 1317  
Foreshore Licence Ref: FS006838

Data collected: INFOMAR/INSS/MDM DATA 02-17	Sheet 1317-WINS-AL-04
Drawing issued: 26 JULY 2018 Drafted by: Kevin Whyte	
Scale 1:25,000	Plot size ISD A1